

# 45

Rockville Regional Transit Center – Woodley Gardens –  
 Rockville Senior Center (Certain Trips Only) – College Pkwy –  
 Baltimore Rd – Twinbrook Pkwy – Twinbrook Station

# RIDE ON

MONTGOMERY COUNTY TRANSIT

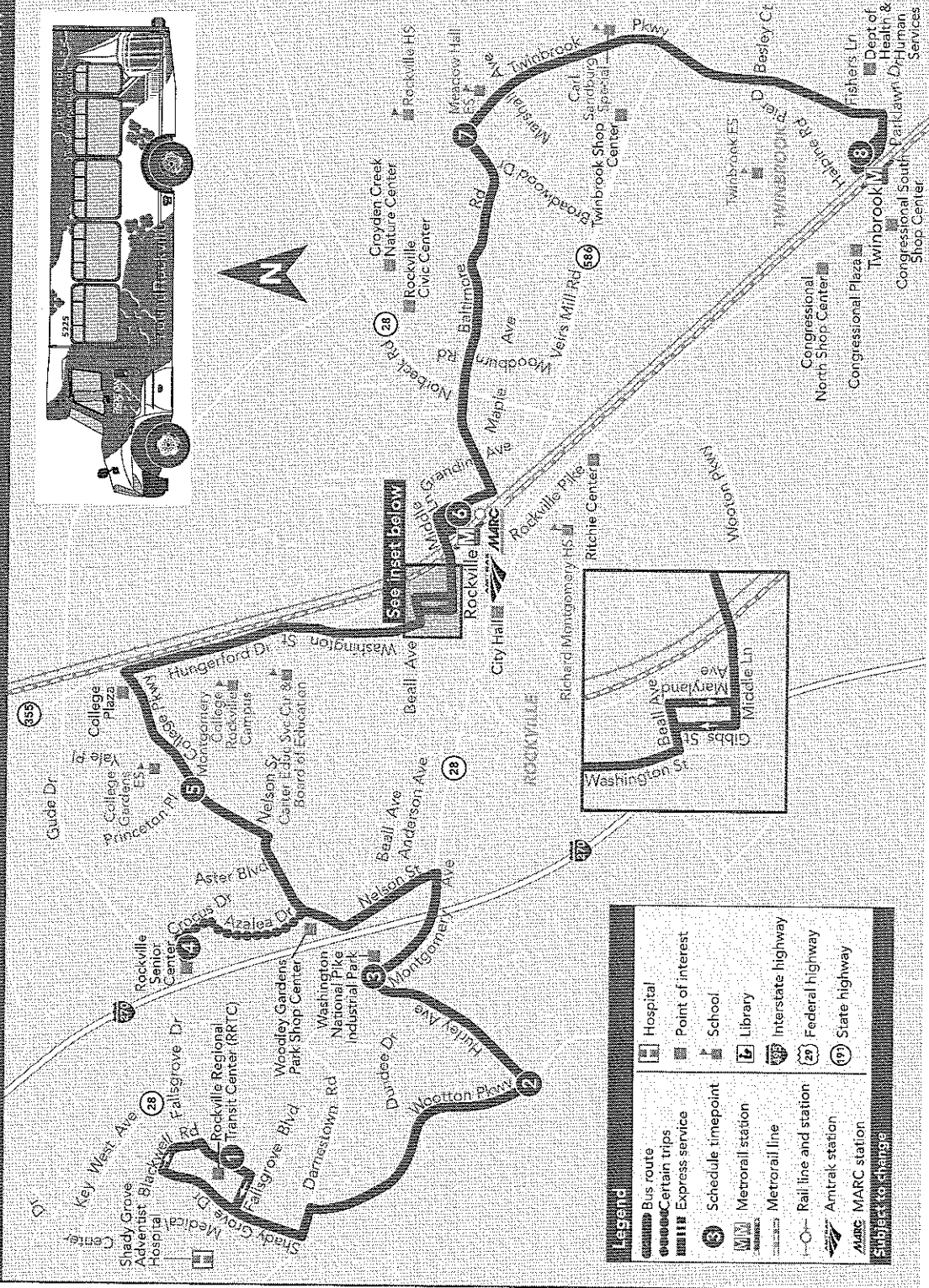
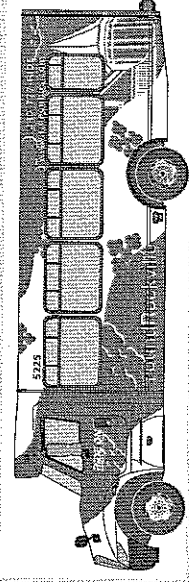

See inset below

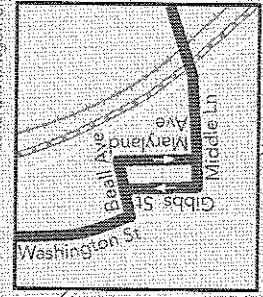

Legend	
	Bus route
	Certain trips
	Express service
	Schedule timepoint
	Metrorail station
	Metrorail line
	Rail line and station
	Antrak station
	MARC station
	Hospital
	Point of interest
	School
	Library
	Interstate highway
	Federal highway
	State highway

Subject to change

**LEGEND**  
 L.P. Lamp Post  
 S.S.M.H. Sanitary Sewer Manhole  
 S.D. Storm Drain  
 T.B. Telephone Box  
 F.H. Fire Hydrant

**Notes:**  
 1. Legend applies to sheets 1 thru 3 only  
 2. All elevations are in datum of Wash Suburban Commission

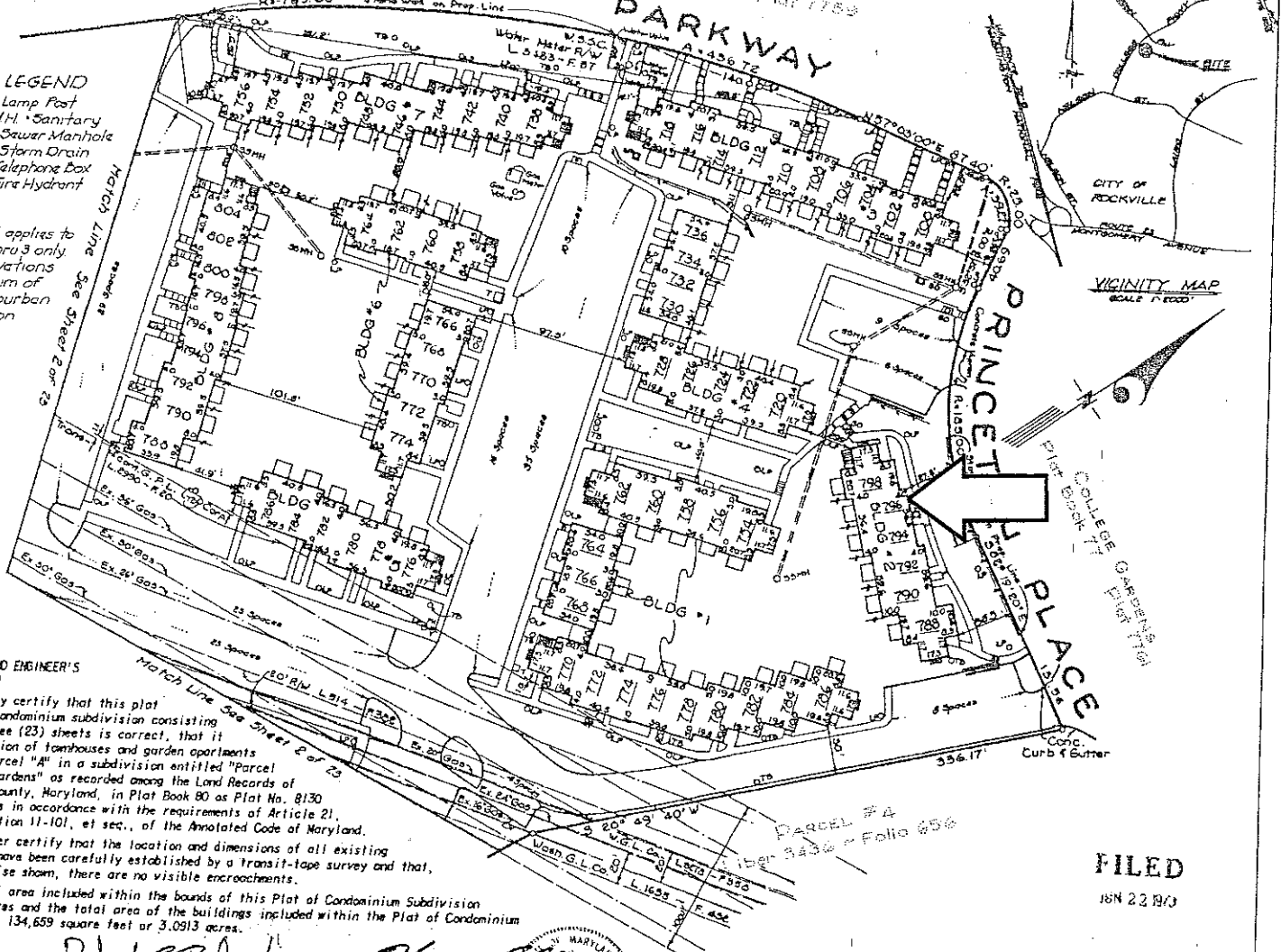

VICINITY MAP  
 SCALE 1"=100'

**SURVEYOR'S AND ENGINEER'S CERTIFICATION**

We hereby certify that this plat and plan of condominium subdivision consisting of twenty-three (23) sheets is correct, that it is a subdivision of townhouses and garden apartments located on Parcel "A" in a subdivision entitled "Parcel 'A' College Gardens" as recorded among the Land Records of Montgomery County, Maryland, in Plat Book 80 as Plat No. 8130 and that it is in accordance with the requirements of Article 21, Title XI, Section 11-101, et seq., of the Annotated Code of Maryland.

We further certify that the location and dimensions of all existing improvements have been carefully established by a transit-tape survey and that, unless otherwise shown, there are no visible encroachments.

The total area included within the bounds of this Plat of Condominium Subdivision is 19.5220 acres and the total area of the buildings included within the Plat of Condominium Subdivision is 134,659 square feet or 3.0913 acres.

5/13/73  
 Date  
 Robert C. Scharf  
 Registered Professional Engineer  
 Md. No. 3602

Harry L. Stoner, III  
 Registered Land Surveyor  
 Md. No. 2363

**OWNER'S DEDICATION AND CERTIFICATION**

Plymouth Green Apartments Limited Partnership, by Carl M. Freeman Associates, Inc., General Partner, described in the Surveyor's and Engineer's Certification, hereby adopts this plat and plan of condominium subdivision consisting of twenty-three (23) sheets pursuant to the provisions and requirements of Article 21, Title XI, Section 11-101, et seq., of the Annotated Code of Maryland.

5-13-73  
 Date  
 Robert B. Friedman, Sr. Vice President

Plymouth Green Apartments Limited Partnership  
 By Carl M. Freeman Associates, Inc., General Partner  
 Carl M. Freeman, President

PLAT OF CONDOMINIUM SUBDIVISION  
 SHEET NR 1 OF 23

**PLYMOUTH GARDENS  
 CONDOMINIUM**

CITY OF ROCKVILLE  
 MONTGOMERY COUNTY MARYLAND  
 SCALE: 1"=50' DATE: APRIL 1973

GREENHORNE & O'MARA  
 ENGINEERS ARCHITECTS-PLANNERS-SURVEYORS  
 6715 KENILWORTH AVENUE  
 RIVERDALE MARYLAND 20840

FILED  
 JUN 22 1973

121354  
 833  
 100-11

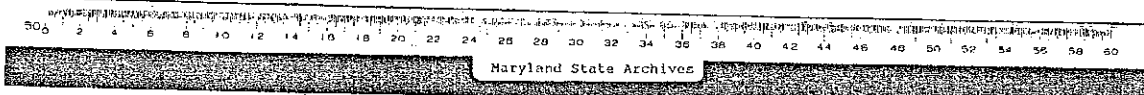

Handwritten initials and a large signature.